

Manufatti in cemento SPADA S.R.L.

SCHEMA TECNICA COPERTINE PER MURO

Tipo Vibrocompresso

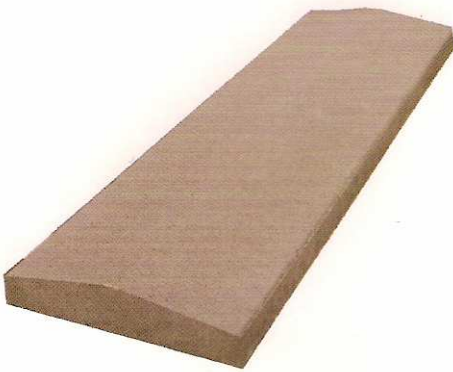
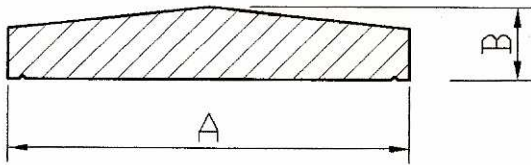

| DATI TECNICI | | | | |
|---------------------|----|---|-----|---------|
| Tipo | A | B | L | Peso Kg |
| Spessore muro cm 20 | 30 | 6 | 100 | 37 |
| Spessore muro cm 25 | 36 | 6 | 100 | 46 |



Tipo Vibrogettato

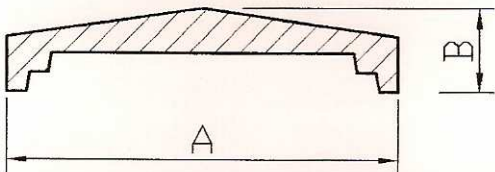

| DATI TECNICI | | | | |
|---------------------|----|---|-----|---------|
| Tipo | A | B | L | Peso Kg |
| Spessore muro cm 15 | 25 | 6 | 100 | 22 |
| Spessore muro cm 20 | 30 | 6 | 100 | 25 |
| Spessore muro cm 25 | 35 | 6 | 100 | 32 |